

Skin beautification science generated from light and ocean

MOONPEARL

EXTRA





Skin beautification science generated from light and ocean

Luster and translucence reveal a regal radiance.

The mystical power of the sea awakens the beauty potential lying dormant within you.

Nature's energy holds the key, promoting skin with supple elasticity and a youthful freshness.

Light and the sea.

Together they bring you the timeless aesthetic of beautiful skin.

Ensure a more beautiful future for your skin, with the elegance of a pearl softly capturing the light.

MOONPEARL

EXTRA

Using the bounty of the sea to promote
supple skin with a regal air.

Skin looks firmer from the moment of application.
Destress^{*1} skin and restore its suppleness with this
rich serum.

MOONPEARL EXTRA EMULSION <Beauty serum>

30mL ¥22,000 (including tax)



Exceptional^{*2} moisture and plumping effect.
Every heartbeat enhances your skin's beauty
with this moisturizing radiance lotion.

MOONPEARL EXTRA LOTION <Lotion>

140mL ¥22,000 (including tax)



For an uplifted, regal countenance.
Elasticity^{*3} cream provides skin with an almost
tangible boost of suppleness.

MOONPEARL EXTRA CREAM <Moisturizing cream>

30 g ¥33,000 (including tax)



Clean formula

Fragrance-free / Pigment-free / Formulated with ultrapure water / Free from parabens, BHT, mineral oil, and sodium lauryl sulfate
Allergy-tested product (however, this does not guarantee all users will be free from allergic reactions)

Signs emerge on our skin. Signs that our skin is losing its suppleness and elasticity as we age. The collagen and elastin that support supple skin progressively decline with age.

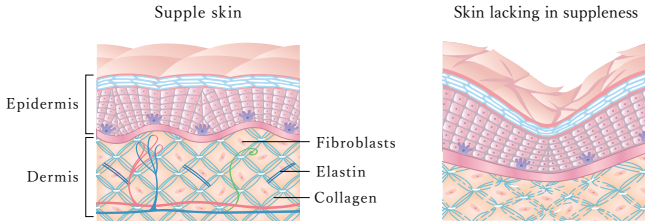

Aging care*1 offered by MOONPEARL EXTRA

Pearls promote translucence, while the sea that nurtures them is the source of life itself. MOONPEARL EXTRA harness their power to promote firmer, more supple skin from its very foundations².



Unique new ingredient Pearl Silk^{®3}

(Contained in all items)

This ingredient is extracted from the byssus filaments of pearl-producing Akoya oysters. Targeting skin's ability to recharge its elasticity, which is a factor in declining suppleness as we age, Pearl Silk[®] supports supple skin from its very foundations².



Unique new ingredient Codium cylindricum extract^{*4}

(Contained in EXTRA EMULSION)

This extract obtained from the dark green seaweed *Codium cylindricum* targets elastin, an essential component of supple skin that promotes elasticity.



Unique ingredient Black Pearl Conchiolin^{®5} & New ingredient Paeonia suffruticosa root extract^{*6}

(Black Pearl Conchiolin[®]: Contained in all items Paeonia suffruticosa root extract: Contained in EXTRA EMULSION and EXTRA CREAM)

Our unique ingredient Black Pearl Conchiolin[®] is derived from the black-lip pearl oyster, while Paeonia suffruticosa root extract is obtained from the peony, prized in China since ancient times as the "king of flowers." Working in combination, these two ingredients focus on skin's moisture levels, which are depleted by the effects of aging and ultraviolet rays, among others. Together, they promote firmer-looking skin.



*1 Age-appropriate care *2 Stratum corneum *3 Hydrolyzed pearl oyster byssus extract (conditioner) *4 Conditioner *5 Hydrolyzed conchiolin (moisturizer) amino acids and peptides extracted from the nacreous layer of black-lip pearl oyster (*Pinctada margaritifera*) shells *6 Moisturizer *7 Image is for illustration purposes.

Easy warm-up using EXTRA EMULSION

Your MOONPEARL EXTRA skincare routine begins with EXTRA EMULSION, followed by EXTRA LOTION and finally EXTRA CREAM. This 30-second easy warm-up massage using EXTRA EMULSION activates the skin itself, starting by enhancing the internal environment so that the skincare ingredients can work effectively.

30-second massage

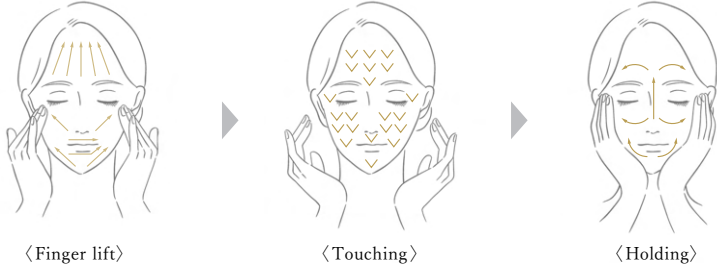
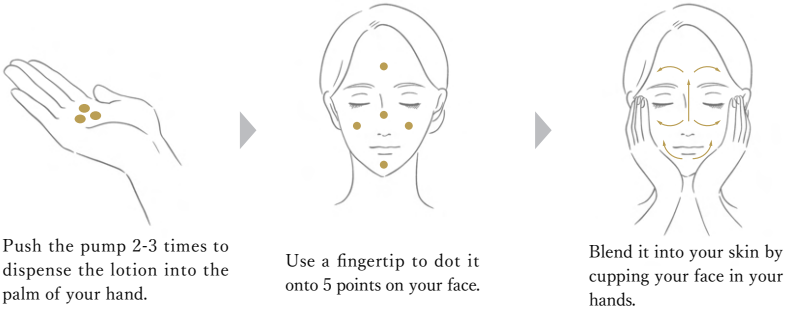

- Lift the skin three times in each area with the pads of three fingers on each hand.
 - From your chin to your temples
 - From the sides of your nose to your temples
 - From above your eyebrows to your hairline
- Alternating between sides, lift the skin around your mouth three times on each side, pinching it between your index and middle fingers.

Gently touch your face at random with the pads of three fingers on each hand, as though playing the piano.

Blend it into your skin by cupping your face in both hands.

STEP



1 EXTRA EMULSION



2 EXTRA LOTION



3 EXTRA CREAM